

# Great Room

With sweeping mountain views and a fireplace, the Great Room is perfect for small receptions, speaking engagements, and elegant dinners. The Great Room is available to student groups, campus groups, and off-campus groups. Pre-set for 30 guests, the set up consists of (5) 60" round wood tables with 6 chairs at each. Rounds can be added for a maximum banquet set up for 48 guests.

## Audio Visual Equipment

- Retractable permanent screen
- Permanent whiteboard
- Media tech cart which includes:
  - A mini PC
  - A connection to the projector
  - 1 DVD/VCR player
  - RCA connector

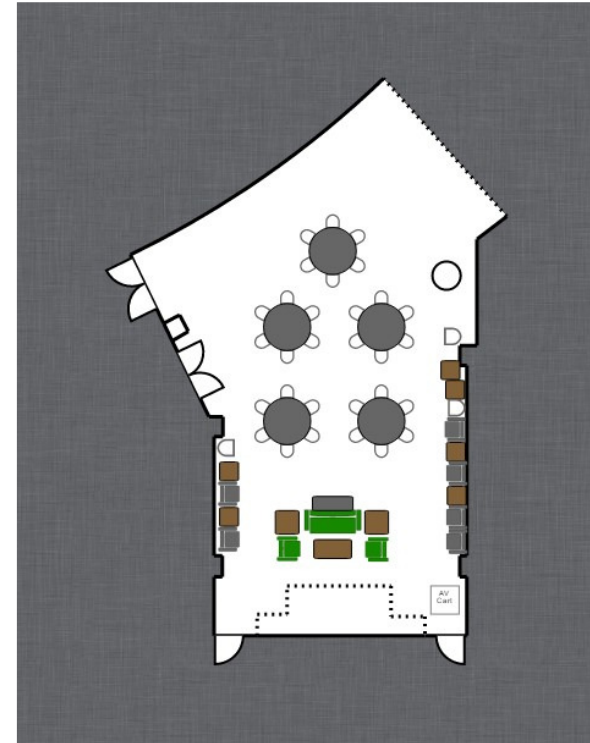

## Please Note

- The sponsor must provide tables covers for the round pre-set tables when refreshments are included.
- Balcony access is available, only with the supervision of a Joe Crowley Student Union employee.